

BUSINESS DEVELOPMENT
COMMON AREA INVENTORY KEY

RMU
 STATIC
K OR K KIOSK
SK SEASONAL
5555 OR 5555
5555 SEASONAL
▲ EVENT AREAS
\$ ATM
V VENDING

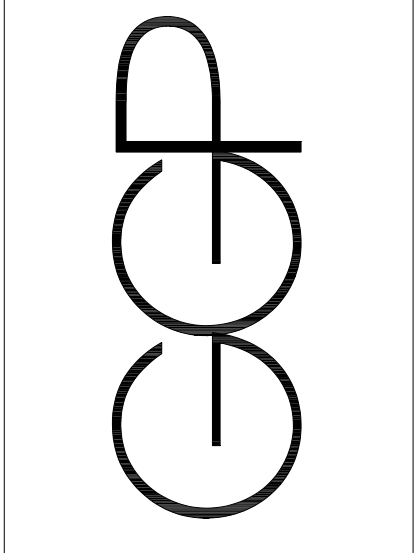
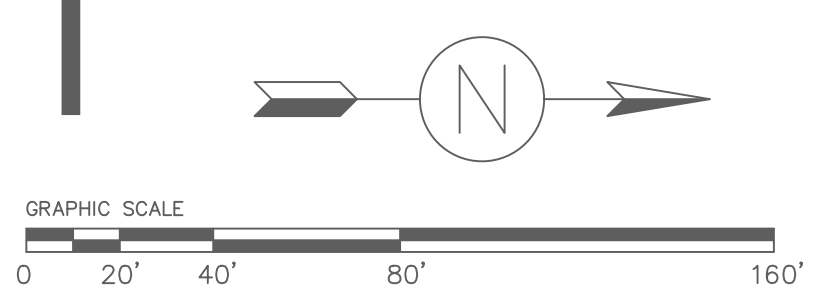
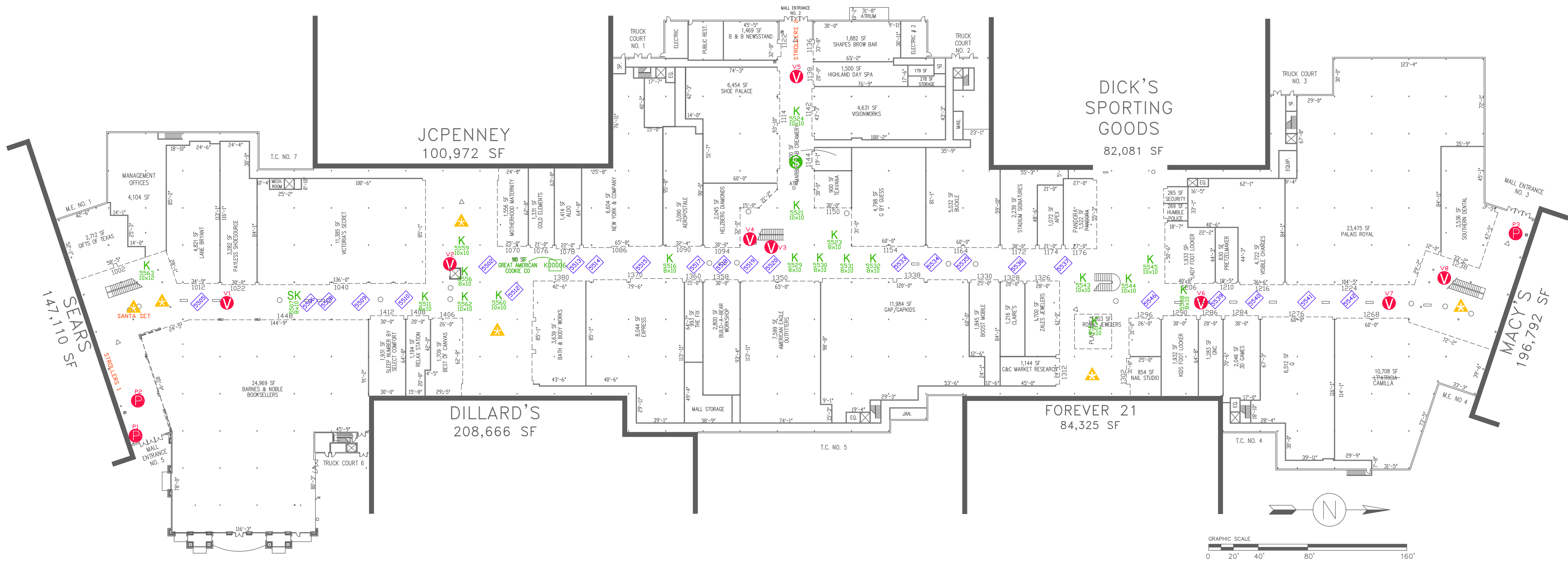

DEERBROOK MALL
20131 HIGHWAY 59 NORTH
HUMBLE, TEXAS 77338

TENANT NAMES SHOWN ON THIS PLAN REPRESENT LEASES WHICH ARE EXECUTED, OUT FOR SIGNATURE, OR IN NEGOTIATION. SPECIFIC NAMES, LOCATIONS, DIMENSION OF ANY STORE, ENTRANCE, OR IMPROVEMENT ARE SUBJECT TO CHANGE, MODIFICATION AND DELETION BY LANDLORD OR OTHER PARTIES, AND ARE NOT A REPRESENTATION OF, OR WARRANTY AS TO THE OPENING OR CONTINUED OPERATION OF ANY STORE NAMED OR DEPICTED ON THIS PLAN.

NOTWITHSTANDING THAT CERTAIN OF THE ELEMENTS, INCLUDING BUT NOT LIMITED TO THE TENANT NAMES, SHOWN ON THIS PLAN MAY BE INDICATED AS FUTURE OR PROPOSED. LANDLORD MAKES NO REPRESENTATION THAT THE FUTURE DEVELOPMENT WILL OCCUR AS SHOWN.

ALL TENANT LEASE AREAS ARE MEASURED FROM THE CENTERLINE OF INTERIOR PARTITION, FROM THE OUTSIDE FACE OF EXTERIOR WALL, FROM THE FULL THICKNESS OF CORRIDOR AND SHAFT WALLS AND FROM THE EDGE OF SLAB AT ANCHOR STORE WALLS.

PROJECT NO: 3701
DRAWN BY: TMK
COPYRIGHT: GGP Inc.

DESCRIPTION
**LEASE PLAN
LOWER LEVEL**

SHEET NO.
BDP1

DATE: February 2018

BUSINESS DEVELOPMENT
COMMON AREA INVENTORY KEY

RMU
 STATIC
K OR K 5555 KIOSK
SK 5555 SEASONAL
▲ EVENT AREAS
\$ ATM
V VENDING

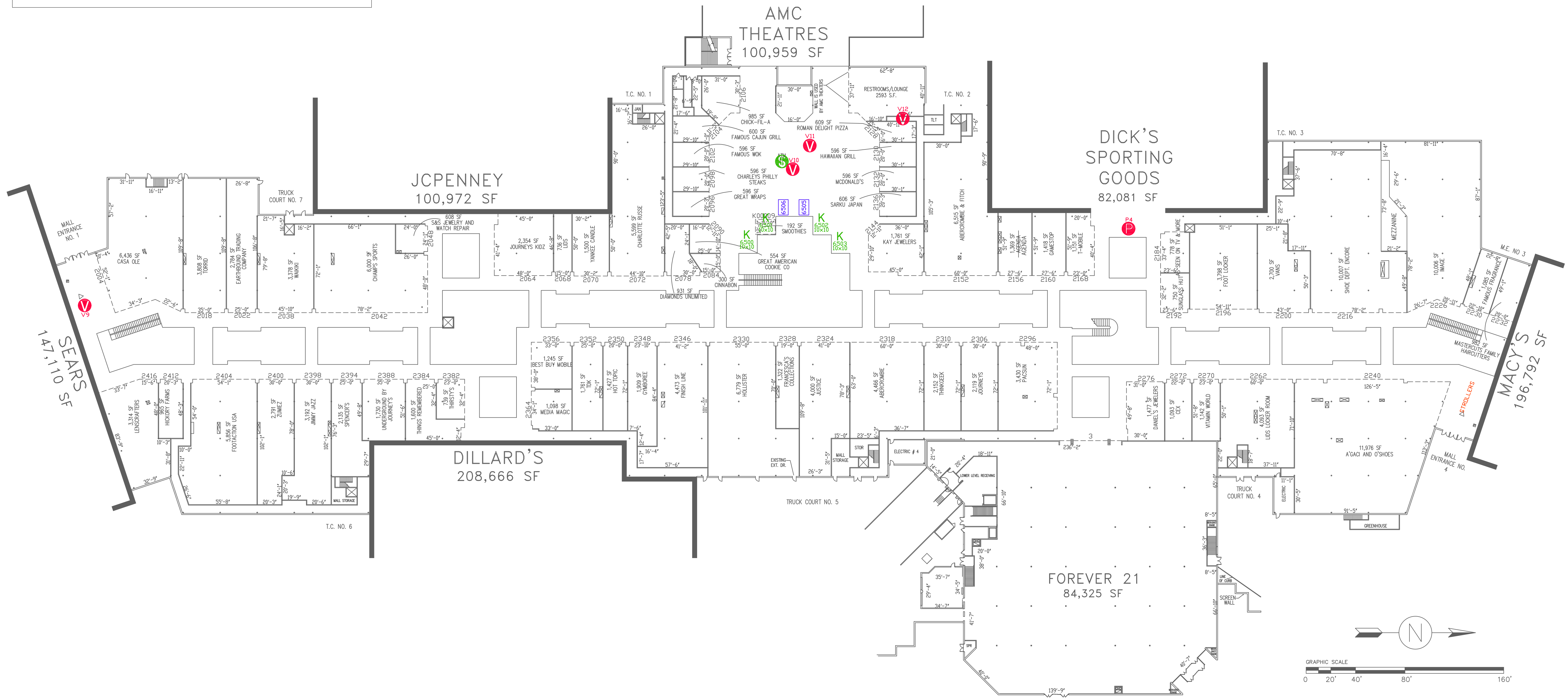

DEERBROOK MALL

20131 HIGHWAY 59 NORTH
HUMBLE, TEXAS 77338

TENANT NAMES SHOWN ON THIS PLAN REPRESENT LEASES WHICH ARE CHECKED, OUT FOR SIGNATURE, OR IN NEGOTIATION. SPECIFIC NAMES, LOCATIONS, DIMENSION OF ANY STORE, ENTRANCE, OR IMPROVEMENT ARE SUBJECT TO CHANGE, MODIFICATION AND DELETION BY LANDLORD OR OTHER PARTIES, AND ARE NOT A REPRESENTATION OF, OR WARRANTY AS TO THE OPENING OR CONTINUED OPERATION OF ANY STORE NAMED OR REFERRED TO ON THIS PLAN.

NOTWITHSTANDING THAT CERTAIN OF THE ELEMENTS, INCLUDING BUT NOT LIMITED TO THE TENANT NAMES, SHOWN ON THIS PLAN MAY BE INDICATED AS FUTURE OR PROPOSED, LANDLORD MAKES NO REPRESENTATION THAT THE FUTURE DEVELOPMENT WILL OCCUR AS SHOWN.

ALL TENANT LEASE AREAS ARE MEASURED FROM THE CENTERLINE OF INTERIOR PARTITION, FROM THE OUTSIDE FACE OF EXTERIOR WALL, FROM THE FULL THICKNESS OF CORRIDOR AND SHAFT WALLS AND FROM THE EDGE OF SLAB AT ANCHOR STORE WALLS.

PROJECT NO: 3701
 DRAWN BY: TMK
 COPYRIGHT: GGP Inc.

DESCRIPTION
 LEASE PLAN
 UPPER LEVEL

SHEET NO.
BDP2

DATE: February 2018